

D8 Fce - DIMENSIONALI DIMENSIONS

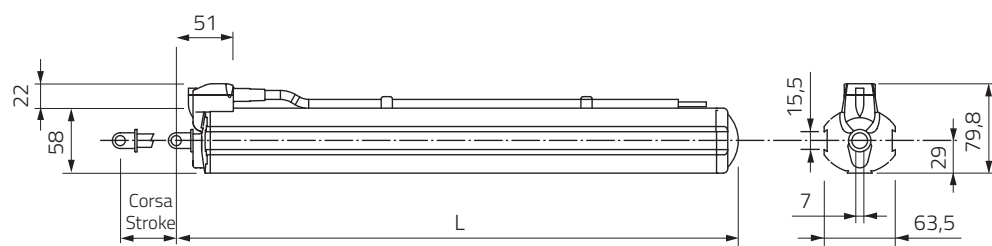

D8 Fce - LUNGHEZZE LENGTHS

Corsa / Stroke	200 mm	L = 318,8 mm
Corsa / Stroke	300 mm	L = 418,8 mm
Corsa / Stroke	400 mm	L = 518,8 mm

D8 Fce - 230V AC 50Hz

CODICE CODE	DESCRIZIONE DESCRIPTION	CORSA STROKE	SPINTA/TRAZIONE THRUST/TENSILE	POTENZA POWER	GRADO DI PROTEZIONE PROTECTION DEGREE	VELOCITA' MIN. SPEED MIN.	COLORE COLOR
2700292	D8 Fce	200 mm	500 N	175 W	IP 55	ca. 12 mm/s	Argento / Silver
2700293	D8 Fce	300 mm	500 N	175 W	IP 55	ca. 12 mm/s	Argento / Silver
2700297	D8 Fce	400 mm	500 N	175 W	IP 55	ca. 12 mm/s	Argento / Silver

I valori prestazionali riportati nella tabella sono valori medi verificati in condizioni di utilizzo standard / The values indicated on the table are average values were recorded in condition of normal use

D8 Fce - ACCESSORI DI FISSAGGIO FIXING ACCESSORIES

CODICE CODE	DESCRIZIONE DESCRIPTION
2700102	Perno anteriore per versioni frangisole / Front pin for sunshades application
2700064	Staffa anteriore per infisso / Window front bracket
2700124	Staffa supporto attuatore argento / Silver actuator support bracket
2700107	Staffa anteriore per infisso + solo accessori per staffa attuatore / Window front bracket + actuator support bracket accessories only

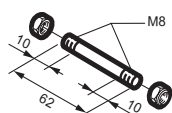

2700102

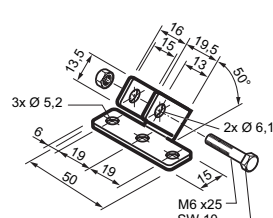

2700064

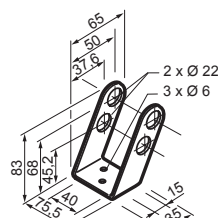

2700124

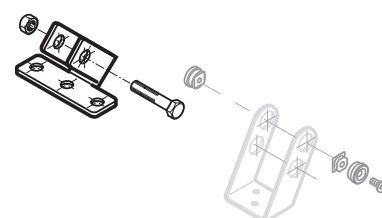

2700107